

Product Information

TF5119



Size: 36" sq x 18" tall

Weight: 825 lbs.

Material: Concrete

Reinforcing: 3/8" Dia Steel Rebar

Concrete Finish Options

- Standard Color Palette

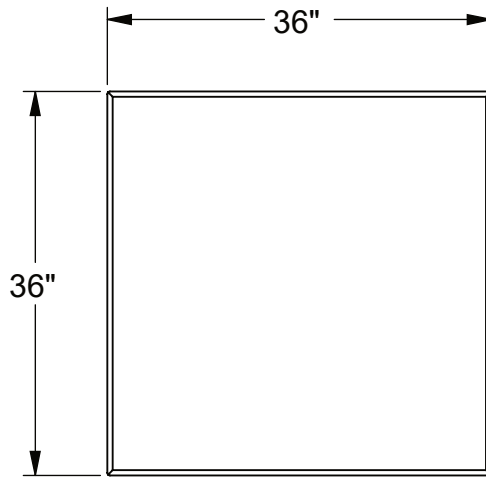

1 TOP VIEW

R1/4" VERTICAL EDGES; TYP.

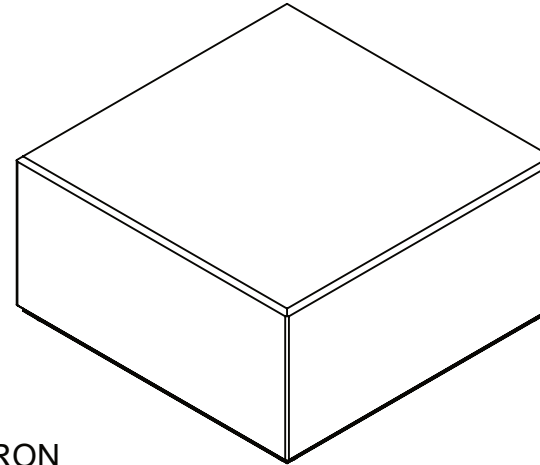

4 ISO

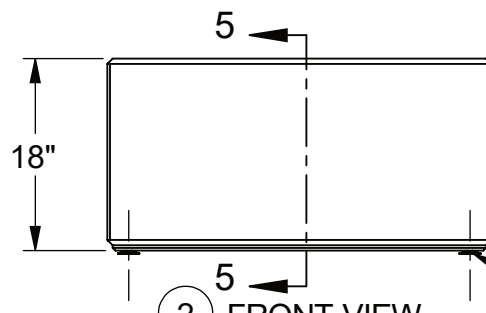

2 FRONT VIEW

1/2" CHAMFER ON TOP EDGES

LEVELING FEET

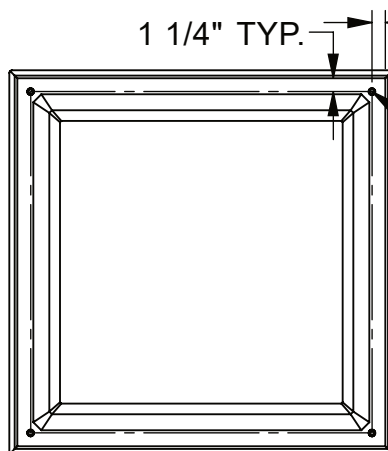

3 BOTTOM VIEW

1/2" FERRULE INSERTS

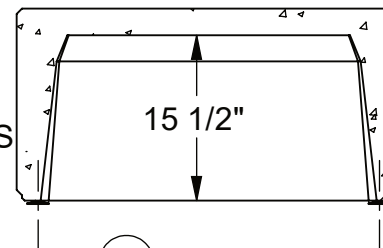

5 SECTION

REVISIONS

	BY	DATE	NOTE
1	-		-
2	-		-
3	-		-
4	-		-
5			

CONFIDENTIAL INFORMATION
THESE DRAWINGS, SPECIFICATIONS AND OTHER INFORMATION AND DOCUMENTS ACCOMPANYING THEM ARE THE CONFIDENTIAL AND PROPRIETARY PROPERTY OF WAUSAU TILE, INC. THE DRAWINGS THEMSELVES SHALL BELONG TO THE OWNER FOR USE ONLY ON THE PROJECT. ANY ADDITIONAL USES SHALL REQUIRE THE PRIOR WRITTEN APPROVAL OF WAUSAU TILE, INC. THE PROPRIETARY INFORMATION CONTAINED WITHIN THE DRAWINGS AND THE DOCUMENTS AND SHALL REMAIN THE SOLE PROPERTY OF WAUSAU TILE, INC.

UNLESS OTHERWISE SPECIFIED
DIMENSIONS SHOWN ARE
ROUNDED TO THE CLOSEST
FRACTION ± 1/16"

DRAWING SCALE: NOT TO SCALE

FABRICATION TOLERANCE: ± 1/8"

36" SQ X 18"
BENCH

DRAWN BY: XXX DATE: 1/1/2000

CO NUMBER: -

WEIGHT: #

PRODUCT NUMBER:
TF5119